



Caratteristiche - Specifications

Materiale - Material	Alluminio - Aluminum
Peso al metro - Weight per meter	1880 g
Lunghezza - Length	Su misura - Custom made
Grado protezione - IP rating	IP20
Finitura standard verniciata - Standard painted finish	<input type="checkbox"/>
Verniciatura optional - Optional painting	<input type="checkbox"/> <input type="checkbox"/> <input type="checkbox"/> <input type="checkbox"/>
Marcature - Marking	ERC CE

Caratteristiche Elettriche - Electrical specifications

Gruppo di alimentazione - Power supply unit	Remoto/ Remote
Tensione di alimentazione - Supply voltage	24 Vdc
Potenza totale - Total power	29 W/m
Classe di isolamento - Insulation class	<input type="checkbox"/>
Dimmerazioni disponibili - Dimming available	Casambi - Dali - Push - 1-10 V

Sorgente luminosa - Light source

Tipo di sorgente - Type of source	LED		
Temperatura colore - Color temperature	2700 K	3000 K	4000 K
Flusso nominale LED - Nominal LED flux	2832 lm/m	2909 lm/m	3151 lm/m
Efficienza modulo LED - LED module efficiency	98 lm/W	100 lm/W	109 lm/W
Classe efficienza energetica LED - Efficiency class LED	F		
Durata - Duration life	L80/ B10 (25 °C) > 50.000 h		

Apparecchio - Device

Temperatura colore - Color temperature	2700 K¹	3000 K²	4000 K³
Flusso lampada - Light flux	1920 lm/m	1974 lm/m	2137 lm/m
Efficienza lampada LED - LED lamp efficiency	66 lm/W	68 lm/W	73 lm/W
Indice rosso saturo - Saturated red colour index (R9)	>92	>96	>98
Indice di resa cromatica - Colour rendering index (Ra)	97		
SDCM	3		
Rischio fotobiologico - Photobiological risk	RG 0		

Caratteristiche sistema ottico - Optical system characteristics

Materiale dell'ottica - Material lens	Policarbonato - Polycarbonate
---------------------------------------	--------------------------------------

* Schermo disponibile in lunghezze fino a 6m. Screen available in lengths up to 6m.

Codice prodotto - Product Code

¹ PWXL_56L_WW2_9_SUN

² PWXL_56L_WW9_SUN

³ PWXL_56L_NW9_SUN

PWXL 29W SUNLIKE

SISTEMA DI FISSAGGIO - FASTENING SYSTEM

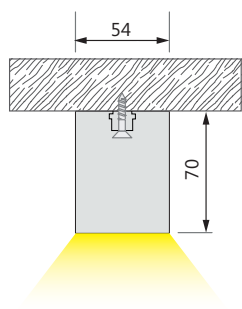

Plafone - Ceiling

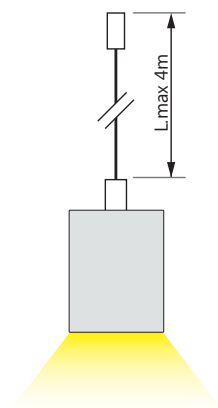

Sospensione - Suspension

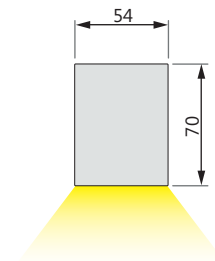

DATI FOTOMETRICI - PHOTOMETRIC DATA

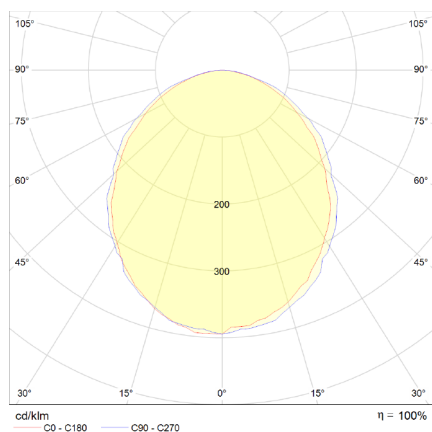

Ottica 107°

ACCESSORI - ACCESSORIES

CAVI PER SOSPENSIONI - SUSPENSION CABLES



SEMITRASPARENTE
SEMITRASPARENTE



TINTA UNITA NERO
EFFETTO SETA
BLACK PLAIN COLOUR
SILK EFFECT



TINTA UNITA BIANCO
EFFETTO SETA
WHITE PLAIN COLOUR
SILK EFFECT

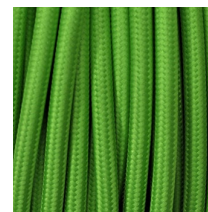

TINTA UNITA VERDE
EFFETTO SETA
GREEN PLAIN COLOUR SILK
EFFECT



TINTA UNITA ROSSO
EFFETTO SETA
RED PLAIN COLOUR SILK
EFFECT



TINTA UNITA
NERO TRECCIATO
BLACK PLAIN
BRAIDED COLOUR



LINO NATURALE GRIGIO
NATURAL LINEN GRAY

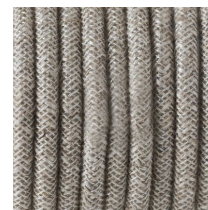

LINO NATURALE
MARRONE NATURAL
LINEN BROWN

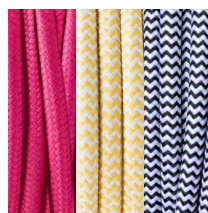

*SU RICHIESTA
*ON REQUEST

Per le lampade a sospensione è possibile scegliere tra una vasta gamma di modelli di cavi. Il kit a sospensione è dotato di tiranti in acciaio della lunghezza di max 4 metri.
For suspensions lamps it's possible to choose through different types of cables. The suspensions kit has steel tie rods with max 4 meters length.



CUT ANGLE 45° + 45°

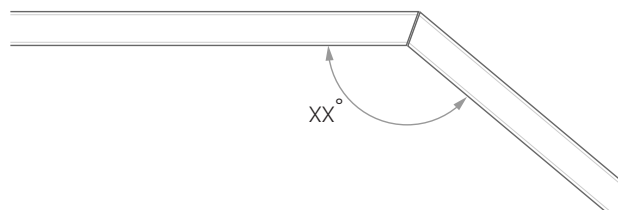

CUSTOM CUT ANGLE

ACCESSORI - ACCESSORIES

ROSONI PORTA ALIMENTATORE - POWER SUPPLY BOXES

VERSIONE CLASSICA - CLASSIC VERSION

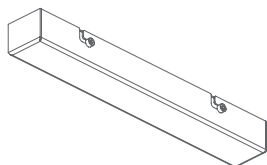

PORTA ALIMENTATORE S
POWER SUPPLY BOX S

Exterior dimensions: 280 x 45 x h 34 mm

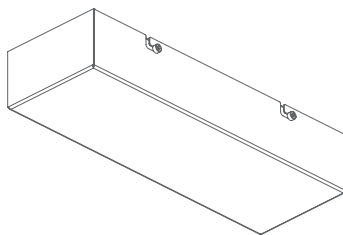

PORTA ALIMENTATORE M
POWER SUPPLY BOX M

Exterior dimensions: 292 x 103 x h 58 mm

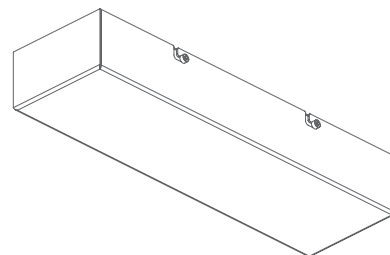

PORTA ALIMENTATORE L
POWER SUPPLY BOX L

Exterior dimensions: 352 x 113 x h 58 mm

VERSIONE TONDA - ROUND VERSION

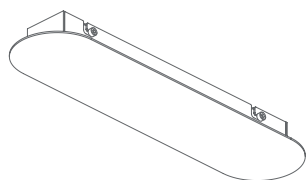

PORTA ALIMENTATORE TONDO S
POWER SUPPLY BOX ROUND S

Exterior dimensions: 345 x 85 x h 36 mm

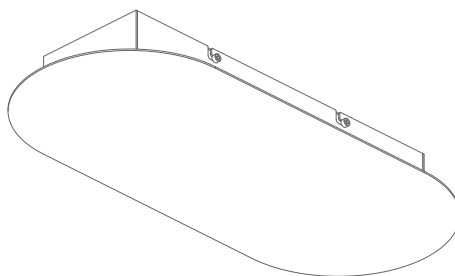

PORTA ALIMENTATORE TONDO S
POWER SUPPLY BOX ROUND S

Exterior dimensions: 465 x 210 x h 60 mm

FINITURE - FINISHES



VERSIONE AAG - AAG VERSION

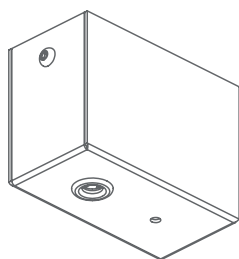

ROSONE METALLICO CON MORSETTIERA
CUP WITH TERMINAL BLOCK

Exterior dimensions: 62 x 32 x 45 mm
2 X 3P: 450V-30A
T: 115°C
sez. 2,5mmq

FINITURE - FINISHES



La serie di porta alimentatori ROUND è particolarmente indicata per tutte le lampade dalle forme sinuose e morbide. I rosoni porta alimentatore sono realizzati in alluminio verniciato bianco o nero (altre finiture su richiesta).
The ROUND series of power supply boxes is particularly suitable for all lamps with sinuous and soft shapes. The power supply boxes are made in aluminum painted white or black (other finishings on request).